



## A100 Compact Series Quarter Turn Electric Actuators

Proval A100 Compact Series electric actuators with 90° quarter turn operation are used for on/off or proportional control of quarter turn butterfly, ball, plug and damper valves.

A100 Compact Series Actuators with a range of 50 ~ 2500 Nm, with their compact structure are manufactured in corrosion resistant epoxy coated aluminum die-cast material, are ideal control of valve equipment for on/off or proportional control in heating and cooling, water/wastewater treatment and other industrial processes.



### Limit Switch

Easy adjustable standard wet and dry contact limit switch-cam structure.

### Indicator

Visual position indicator

### Traceability

All actuators have QR codes for traceability, production and control of process.

### Terminal Wiring

Plug-in terminal provides easy connection.

### Compact Structure

Lightweight and compact design, suitable for installations in space-limited areas.

### Reliable Sealing

Long-acting sealing ring design provides more durable sealing between body and cap.

### Operational Safety

F class insulation motor with temperature control on windings to protect against overheating issues. This feature ensures safety operation of motor.

### Anti-condensation Heater

The heater prevents the condensation and protects the motor against humidity.

### Protection Against Corrosion

Powder epoxy coated aluminum die cast body provides high protection against corrosion. All bolts are stainless steel.

### Manual Control

Z Wrench is supplied with the product for manual control in case of emergency.

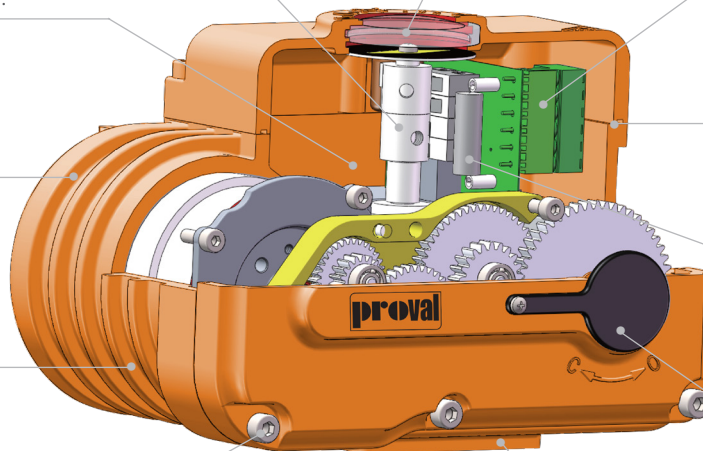

### ISO5211 Flange

Actuators are manufactured according to the ISO5211, with multiple flange holes. Therefore users gain the flexibility to use the same actuators on different valves.

## Technical Specifications

Series	A100 Compact Series (COM)
Torque Range	50~2500 Nm
Ingress Protection	IP67, Optional IP68
Operating Range	On/Off type, S2-15 min. Proportional Type S4-50%
Operating Voltage	AC110V, AC220V ± 10% 1 Ph: 50/60Hz ± Optional: AC/DC24V, AC380V
Operating Temperature	-25°~+60°C
Humidity	≤90% (25°C)
Motor Class	Class F, Thermal Protection
Mounting Flange	ISO5211 Flange, Double Square Shaft Connection
Configuration of Proportional Control	Lost Signal Support, Reverse Signal Identification Function
Manual Control	Manual Z Allen Key
Position Indicator	Horizontal Continuous Position Indicator
Input Signal	On/Off Type: On/Off Signal Proportional Type: Standard 4-20mA (Input Impedance: 150Ω). Optional: 0-10V, 2-10V : Optoelectronic Isolation
Output Signal	On/Off Type: Open/Close Wet Contact and Open/Close Dry Contact Proportional Type: Standard 4-20mA (Output Impedance ≤750Ω). Open/Close Dry Contact Switch. Optional: 0-10V 2-10V Optoelectronic Isolation
Cable Glands	On/Off: 2xPG13.5 Proportional : 2xPG13.5
Anti-condensation Heater	Standard Included
Colour	RAL2004 Anti Corrosive Powder Epoxy Coating

## Technical Specifications

Model	Motor Power (W)	Output Torque Value (Nm)		Cycle Time (Sec.) 50Hz			ISO5211 Top Flange	Spindle Shaft (mm)	Shaft Depth (mm)	Unit Weight (kg)	Manual Control
		AC110V AC220V AC/DC24V	AC380V 3 Phase	AC110V AC220V	AC380V	AC/DC 24V					
COM50	6	50	-	19	-	14	F03/F05/F07	9x9 11x11 14x14	≤20	2	8# Wrench Operation
COM100	25	100		30		23	F05/F07	11x11 14x14 17x17	≤32	4.5	6mm Allen Wrench Operation
COM200	40	200		30		23	F07/F10	14x14 17x17	≤44	10	
COM400	60	400		30		23		22x22			
COM600	90	600		30		23	27x27				
COM1000	120	1000		30		23	22x22				
COM1600	150	1600		42		32	F10/F12	27x27	≤30	26	
COM2500	200	2500		70		53	F14/F16	27x27 36x36	≤48		

## Dimension (mm)

### COM50

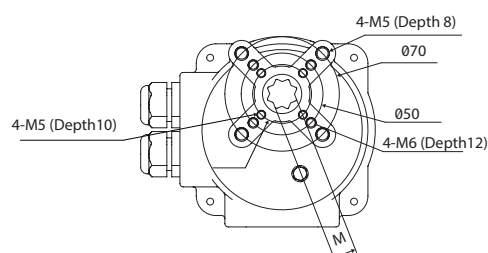
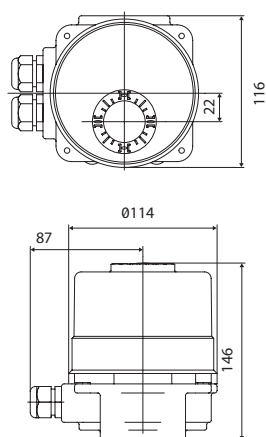
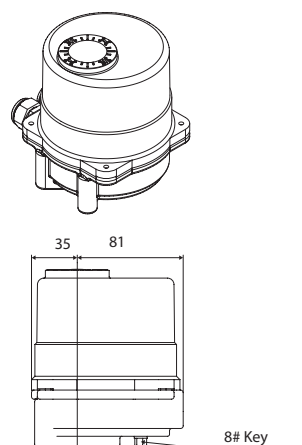

Model	COM50
Stem Square (M)	9x9, 11x11, 14x14
ISO5211 Flange	F03 / F05 / F07
Shaft Height	≤20

### COM100

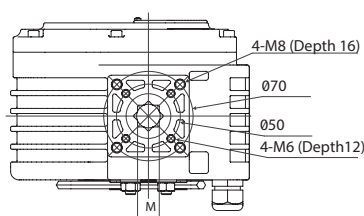
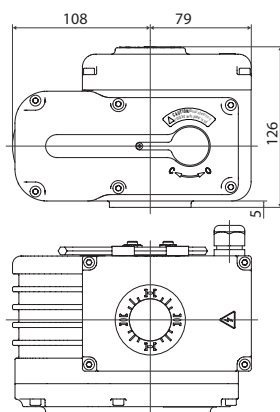
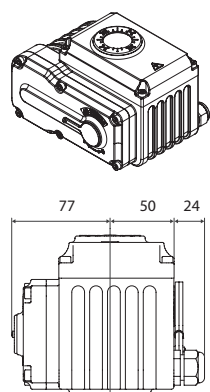

Model	COM100
Stem Square (M)	11x11, 14x14, 17x17
ISO5211 Flange	F05 / F07
Shaft Height	≤32



COM200 / COM400 / COM600

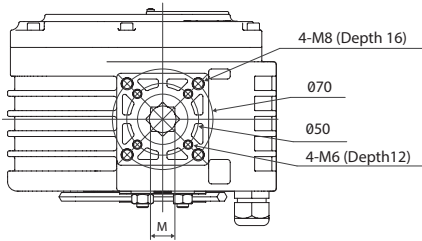
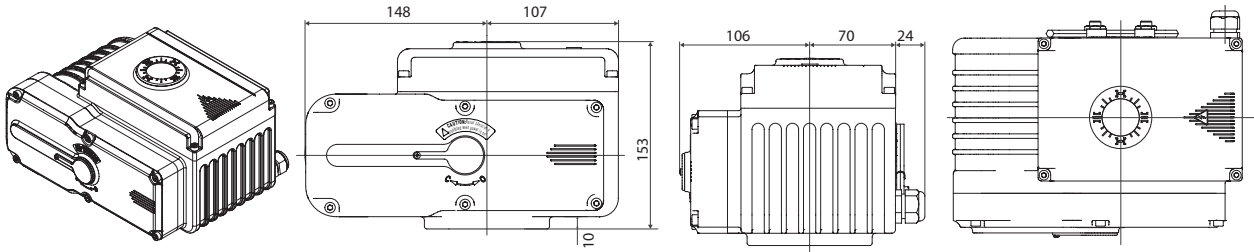

Model	COMM200 / COM400	COM600
Stem Square (M)	14x14, 17x17, 22x22	27x27
ISO5211 Flange	F07 / F10	
Shaft Height	≤44	



COM1000 / COM1600

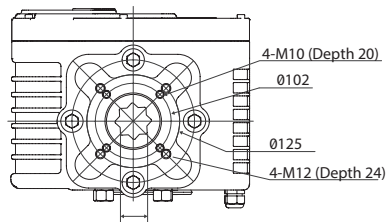
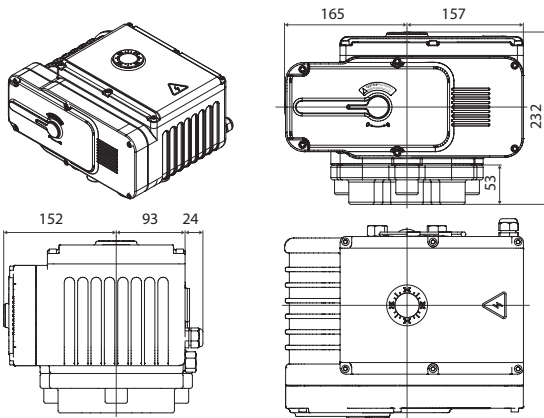

Model	COM1000 / COM1600
Stem Square (M)	22x22, 24x24
ISO5211 Flange	F10 / F12
Shaft Height	≤30



COM2500

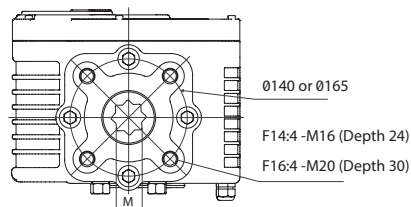
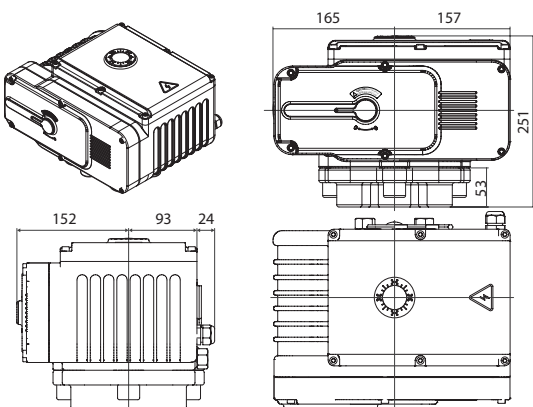

Model	COM2500
Stem Square (M)	27x27, 36x36
ISO5211 Flange	F14 / F16
Shaft Height	≤48

