

V704 Series Threaded End Ball Check Valves

- Available in sizes ranging from DN40 to DN400.
- Ideally suited to be used particularly on the suction and discharge sides of pumps installed in lines containing high viscosity media, slurries.
- Designed according to EN 1074-3 and pressure tested to EN 12266-1
- A minimum back pressure of 0,3 bar is required to ensure leak tightness.

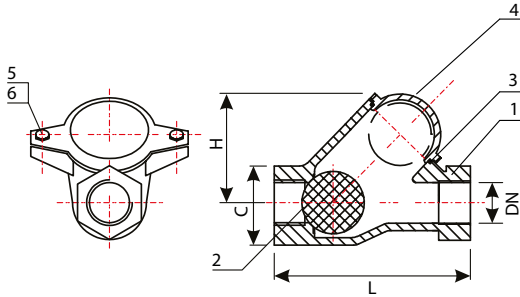

Material List

No	Part Name	Material
1	Body	Epoxy Powder Coated GGG40 Ductile Iron
2	Ball	Rubber Lined Alu
3	O-Ring /Body Seal	EPDM/NBR
4	Cover	Epoxy Powder Coated GGG40 Ductile Iron
5/6	Bolt	AISI316

Dimensions-Threaded End Valve(mm)

Size(DN)	1"	1-1/4"	1-1/2"	2"	2-1/2"	3"
L	125	132	145	174	200	243
C	47	59	70	82	106	132
H	75	75	85	126	113	165
Net Unit Weight (kg)	1,3	1,7	2,6	4,2	5,5	10,0

Pressure Drop Curve

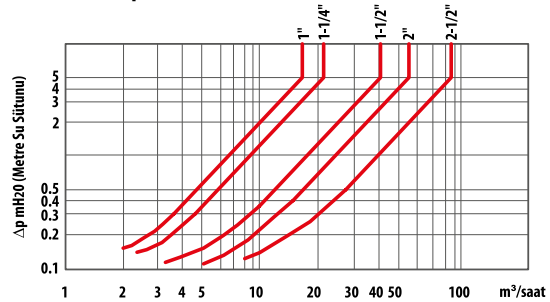

V704 Series Flanged End Ball Check Valves

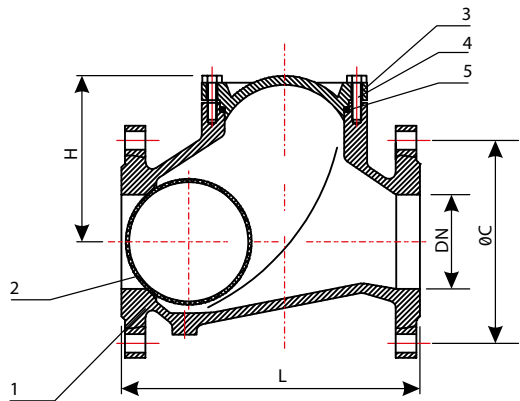

Material List

No	Part Name	Material
1	Body	Epoxy Powder Coated GGG40 Ductile Iron
2	Ball	Rubber Lined Alu
3	Cap	Epoxy Powder Coated GGG40 Ductile Iron
4	Bolt	AISI316
5	O-Ring /Body Seal	EPDM/NBR

Pressure Drop Curve

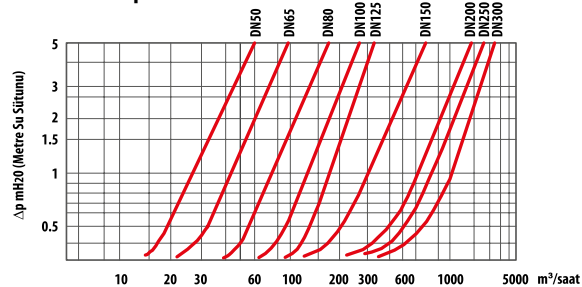

Dimensions- Flanged End Valves (mm)

Size(DN)	40	50	65	80	100	125	150	200	250	300	350	400
L	180	200	240	260	300	350	400	500	600	700	800	900
ØC	PN10	110	125	145	160	180	210	240	295	350	400	460
	PN16	110	125	145	160	180	210	240	295	355	410	470
H	98	106	129	146	194	207	240	322	388	458	610	705
Net Unit Weight (kg)	7,0	7,7	11,2	15,5	22,0	33,0	45,0	90,0	163,0	230,0	290,0	450,0

